



March 2018 - Revision C  
**Quick Coupling Division**  
 8145 Lewis Road  
 Minneapolis, MN 55427  
 phone 763 544 7781  
 fax 763 544 3418

# SUBSEA COUPLING SOLUTIONS

## DSE Series Data Sheet

DSE Series poppet style couplings are the most common design used in subsea applications. Connected and disconnected above water, their compact design is efficient and reliable.



### Features:

- Sizes 1/8" - 1"
- Up to 10,000 psi (690 bar)
- Poppet valves
- O-ring/back up primary seal
- Parker Nitrile O-rings standard
- Body materials: 316 SST
- Internal component materials: 316 SST

### Options:

- Various O-ring materials
- End configurations: NPT, JIC (others available upon request)
- Body material: Nitronic® 50HS
- Special material available upon request

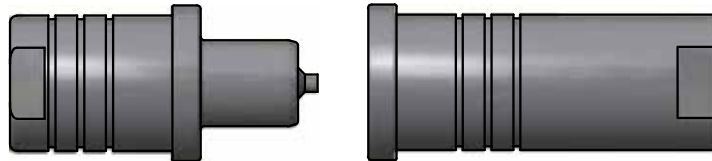

Size	Working Pressure*** (psi/bar)	Rated Working Depth** (ft/m)	Cv per Coupling Half	Separation Force (lb/1000 psi & N/100 bar)	Water Ingress Per Connect (ml)	Length* (in/mm)	Min. Plate Bore Diameter* (in/mm)
1/8"	10,000/690	3000/914	0.4	200/1291	0.4	Male: 2.28/57.9	.875/22.23
						Female: 1.80/45.7	
1/4"	5000/345	3000/914	1.0	245/1580	1.2	Male: 2.03/51.6	.938/23.83
						Female: 2.03/51.6	
3/8"	5000/345	3000/914	1.4	440/2839	2.7	Male: 2.67/67.8	1.203/30.56
						Female: 2.63/67.8	
1/2"	5000/345	3000/914	2.8	700/4517	4.2	Male: 2.93/74.4	1.438/36.53
						Female: 3.09/78.5	
3/4"	5000/345	3000/914	4.0	1350/8711	15.5	Male: 3.74/95.0	1.750/44.45
						Female: 3.97/100.8	
1"	5000/345	3000/914	9.9	2075/13389	34.0	Male: 4.30/109.2	2.375/60.33
						Female: 5.06/128.5	

Data given is representative of the coupling series. Individual couplings may vary based on specific configuration of fittings/optional features.

\* Minimum bore diameter and length are reference. May change for a specific plate configuration.

\*\* Mate/demate topside only.

\*\*\* Max pressure rating dependent on end configuration.