

## ALUMINUM PUMP/MOTOR WI-MK092

HYDRAULIC  
**EXPRESS** PROGRAM

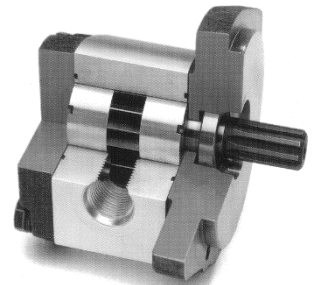

ENGINEERING YOUR SUCCESS.

| PUMP DISPLACEMENT                                | CODE                 | 0020 | 0030 | 0040 | 0050 | 0060 | 0080 |
|--|----------------------|------|------|------|------|------|------|
|  | cm <sup>3</sup> /rev |      | 2.0  | 3.0  | 4.0  | 5.0  | 6.0  |
| MAX. CONTINUOUS PRESSURE                         | BAR                  | 275  | 275  | 275  | 275  | 275  | 275  |
|  | PSI                  | 3988 | 3988 | 3988 | 3988 | 3988 | 3988 |
| MINIMUM SPEED<br>@ Max. outlet pressure          | RPM                  | 500  | 500  | 500  | 500  | 500  | 500  |
| MAXIMUM SPEED<br>@ 0 Inlet & Max outlet pressure | RPM                  | 4000 | 4000 | 4000 | 4000 | 3600 | 3000 |
| PUMP INPUT POWER<br>@ Max. Pressure and 1500 RPM | KW                   | 1.5  | 2.3  | 3.0  | 3.8  | 4.5  | 6.0  |
|  | HP                   | 2.0  | 3.1  | 4.0  | 5.1  | 6.0  | 8.0  |

| PART NO.   | DESCRIPTION               | DISPL (CC) | FLANGE  | SHAFT           | SIDE PORTS                                    | ROTATION |
|------------|---------------------------|------------|---------|-----------------|---|----------|
| 3319111230 | PGP505A0020CJ3H1ND3D2B1B1 | 2.0        | SAE A-A | 1/2" x 1/8" KEY | SAE -8 (3/4"-16 UNF) x SAE -6 (9/16"-18 UNF)  | CW       |
| 3319111543 | PGP505A0030CJ3H1ND3D2B1B1 | 3.0        | SAE A-A | 1/2" x 1/8" KEY | SAE -8 (3/4"-16 UNF) x SAE -6 (9/16"-18 UNF)  | CW       |
| 3319111544 | PGP505A0040CJ3H1ND3D2B1B1 | 4.0        | SAE A-A | 1/2" x 1/8" KEY | SAE -8 (3/4"-16 UNF) x SAE -6 (9/16"-18 UNF)  | CW       |
| 3319111545 | PGP505A0050CJ3H1ND4D2B1B1 | 5.0        | SAE A-A | 1/2" x 1/8" KEY | SAE -10 (7/8"-14 UNF) x SAE -6 (9/16"-18 UNF) | CW       |
| 3319111546 | PGP505M0060CJ3H1ND4D2B1B1 | 6.0        | SAE A-A | 1/2" x 1/8" KEY | SAE -10 (7/8"-14 UNF) x SAE -8 (3/4"-16 UNF)  | CW       |
| 3319111547 | PGP505M0080CJ3H1ND4D3B1B1 | 8.0        | SAE A-A | 1/2" x 1/8" KEY | SAE -10 (7/8"-14 UNF) x SAE -8 (3/4"-16 UNF)  | CW       |

- 2.0cc – 8.0cc DISPLACEMENTS
- 2 BOLT SAE AA MOUNT
- ½" KEYED SHAFT
- SAE PORTING
- CW ROTATION



| PUMP DISPLACEMENT                                | CODE                 | 0060 | 0080 | 0110 | 0140 | 0160 | 0190 | 0230   | 0270 |
|--|----------------------|------|------|------|------|------|------|--------|------|
|  | cm <sup>3</sup> /rev | 6.0  | 8.0  | 11.0 | 14.0 | 16.0 | 19.0 | 23.0   | 27.0 |
| MAX. CONTINUOUS PRESSURE                         | BAR                  | 250  | 250  | 250  | 250  | 250  | 250  | 225    | 190  |
|  | PSI                  | 3625 | 3625 | 3625 | 3625 | 3625 | 3625 | 3262.5 | 2755 |
| MINIMUM SPEED<br>@ Max. outlet pressure          | RPM                  | 500  | 500  | 500  | 500  | 500  | 500  | 500    | 500  |
| MAXIMUM SPEED<br>@ 0 Inlet & Max outlet pressure | RPM                  | 3500 | 3500 | 3500 | 3500 | 3500 | 3250 | 2750   | 2350 |
| PUMP INPUT POWER<br>@ Max. Pressure and 1500 RPM | KW                   | 4.5  | 6.0  | 7.5  | 8.3  | 10.5 | 12.0 | 14.3   | 14.7 |
|  | HP                   | 6.0  | 8.0  | 10.1 | 11.1 | 14.1 | 16.1 | 19.2   | 19.7 |

| PART NO.   | DESCRIPTION               | DISPL (CC) | FLANGE   | SHAFT             | SIDE PORTS  | ROTATION |
|------------|---------------------------|------------|----------|-------------------|---|----------|
| 3349116035 | PGP511M0060CK1H2ND5D4B1B1 | 6.0        | SAE A 2B | 5/8" x 0.156" KEY | SAE -12 (1 1/16 - 12 UN) x SAE -10 (7/8"-14 UNF)    | CW       |
| 3349116036 | PGP511M0080CK1H2ND5D4B1B1 | 8.0        | SAE A 2B | 5/8" x 0.156" KEY | SAE -12 (1 1/16 - 12 UN) x SAE -10 (7/8"-14 UNF)    | CW       |
| 3349116031 | PGP511M0110CK1H2ND6D5B1B1 | 11.0       | SAE A 2B | 5/8" x 0.156" KEY | SAE -16 (1 5/16 - 12 UN) x SAE -12 (1 1/16 - 12 UN) | CW       |
| 3349116032 | PGP511M0140CK1H2ND6D5B1B1 | 14.0       | SAE A 2B | 5/8" x 0.156" KEY | SAE -16 (1 5/16 - 12 UN) x SAE -12 (1 1/16 - 12 UN) | CW       |
| 3349116033 | PGP511M0160CK1H2ND6D5B1B1 | 16.0       | SAE A 2B | 5/8" x 0.156" KEY | SAE -16 (1 5/16 - 12 UN) x SAE -12 (1 1/16 - 12 UN) | CW       |
| 3349116473 | PGP511M0190CK1H2ND6D5B1B1 | 19.0       | SAE A 2B | 5/8" x 0.156" KEY | SAE -16 (1 5/16 - 12 UN) x SAE -12 (1 1/16 - 12 UN) | CW       |
| 3349116038 | PGP511M0230CK1H2ND7D6B1B1 | 23.0       | SAE A 2B | 5/8" x 0.156" KEY | SAE -20 (1 5/8 - 12 UN) x SAE -16 (1 5/16 - 12 UN)  | CW       |
| 3349116039 | PGP511M0270CK1H2ND7D6B1B1 | 27.0       | SAE A 2B | 5/8" x 0.156" KEY | SAE -20 (1 5/8 - 12 UN) x SAE -16 (1 5/16 - 12 UN)  | CW       |

- 6.0cc – 27.0cc DISPLACEMENTS
- 2 BOLT SAE A MOUNT
- 5/8" KEYED SHAFT
- SAE PORTING
- CW ROTATION



| PUMP DISPLACEMENT                                | CODE                 | 0060 | 0080 | 0110 | 0140 | 0160 | 0190 | 0230   | 0270 |
|--|----------------------|------|------|------|------|------|------|--------|------|
|  | cm <sup>3</sup> /rev | 6.0  | 8.0  | 11.0 | 14.0 | 16.0 | 19.0 | 23.0   | 27.0 |
| MAX. CONTINUOUS PRESSURE                         | BAR                  | 250  | 250  | 250  | 250  | 250  | 250  | 225    | 190  |
|  | PSI                  | 3625 | 3625 | 3625 | 3625 | 3625 | 3625 | 3262.5 | 2755 |
| MINIMUM SPEED<br>@ Max. outlet pressure          | RPM                  | 500  | 500  | 500  | 500  | 500  | 500  | 500    | 500  |
| MAXIMUM SPEED<br>@ 0 Inlet & Max outlet pressure | RPM                  | 3500 | 3500 | 3500 | 3500 | 3500 | 3250 | 2750   | 2350 |
| PUMP INPUT POWER<br>@ Max. Pressure and 1500 RPM | KW                   | 4.5  | 6.0  | 7.5  | 8.3  | 10.5 | 12.0 | 14.3   | 14.7 |
|  | HP                   | 6.0  | 8.0  | 10.1 | 11.1 | 14.1 | 16.1 | 19.2   | 19.7 |

| PART NO.   | DESCRIPTION               | DISPL (CC) | FLANGE   | SHAFT        | SIDE PORTS  | ROTATION |
|------------|---------------------------|------------|----------|--------------|---|----------|
| 3349111579 | PGP511M0060CA1H2MD5D4B1B1 | 6.0        | SAE A 2B | SAE A 9T SPL | SAE -12 (1 1/16 - 12 UN) x SAE -10 (7/8"-14 UNF)    | CW       |
| 3349111580 | PGP511M0080CA1H2MD5D4B1B1 | 8.0        | SAE A 2B | SAE A 9T SPL | SAE -12 (1 1/16 - 12 UN) x SAE -10 (7/8"-14 UNF)    | CW       |
| 3349111582 | PGP511M0110CA1H2MD6D5B1B1 | 11.0       | SAE A 2B | SAE A 9T SPL | SAE -16 (1 5/16 - 12 UN) x SAE -12 (1 1/16 - 12 UN) | CW       |
| 3349111583 | PGP511M0140CA1H2MD6D5B1B1 | 14.0       | SAE A 2B | SAE A 9T SPL | SAE -16 (1 5/16 - 12 UN) x SAE -12 (1 1/16 - 12 UN) | CW       |
| 3349111584 | PGP511M0160CA1H2MD6D5B1B1 | 16.0       | SAE A 2B | SAE A 9T SPL | SAE -16 (1 5/16 - 12 UN) x SAE -12 (1 1/16 - 12 UN) | CW       |
| 3349111585 | PGP511M0190CA1H2MD7D6B1B1 | 19.0       | SAE A 2B | SAE A 9T SPL | SAE -20 (1 5/8 - 12 UN) x SAE -16 (1 5/16 - 12 UN)  | CW       |
| 3349111586 | PGP511M0230CA1H2MD7D6B1B1 | 23.0       | SAE A 2B | SAE A 9T SPL | SAE -20 (1 5/8 - 12 UN) x SAE -16 (1 5/16 - 12 UN)  | CW       |
| 3349111587 | PGP511M0270CA1H2MD7D6B1B1 | 27.0       | SAE A 2B | SAE A 9T SPL | SAE -20 (1 5/8 - 12 UN) x SAE -16 (1 5/16 - 12 UN)  | CW       |

- 6.0cc – 27.0cc DISPLACEMENTS
- 2 BOLT SAE A MOUNT
- SAE A 9T SPLINE
- SAE PORTING
- CW ROTATION



| MOTOR DISPLACEMENT                       | MGG2                 | 0010 | 0016 | 0020 | 0025 | 0030  |
|--|----------------------|------|------|------|------|-------|
|  | cm <sup>3</sup> /rev | 3.57 | 6.10 | 7.37 | 9.51 | 11.47 |
| MAX. CONTINUOUS PRESSURE                 | BAR                  | 138  | 138  | 138  | 138  | 104   |
|  | PSI                  | 2000 | 2000 | 2000 | 2000 | 1500  |
| MAX. FLOW<br>Theoretical @ max. 5000 rpm | GPM                  | 4.7  | 8.1  | 9.8  | 12.6 | 15.2  |
| MAXIMUM SPEED                            | RPM                  | 5000 | 5000 | 5000 | 5000 | 5000  |
| OUTPUT TORQUE<br>Per 1000 PSI            | IN-LBS               | 35.0 | 59.0 | 72.0 | 92.0 | 111.0 |

| PART NO. | DESCRIPTION    | DISPL (CC) | FLANGE    | SHAFT       | REAR PORTS                    | ROTATION |
|----------|----------------|------------|-----------|-------------|-------------------------------|----------|
| 0900241  | MGG20010 BA1A3 | 3.57       | SAE AA 2B | 9/16" KEYED | SAE -8 (3/4"-16 UNF)          | BI       |
| 0900242  | MGG20016 BA1A3 | 6.10       | SAE AA 2B | 9/16" KEYED | SAE -8 (3/4"-16 UNF)          | BI       |
| 0900243  | MGG20020 BA1A3 | 7.37       | SAE AA 2B | 9/16" KEYED | SAE -8 (3/4"-16 UNF)          | BI       |
| 0900244  | MGG20025 BA1A3 | 9.51       | SAE AA 2B | 9/16" KEYED | SAE -10 (7/8"-14 UNF)         | BI       |
| 0900245  | MGG20030 BA1A3 | 11.74      | SAE AA 2B | 9/16" KEYED | SAE -10 (7/8"-14 UNF)         | BI       |
| 0900231  | MGG20010 BB1A3 | 3.57       | 4 BOLT    | 9/16" KEYED | SAE -8 (3/4"-16 UNF)          | BI       |
| 0900232  | MGG20016 BB1A3 | 6.10       | 4 BOLT    | 9/16" KEYED | SAE -8 (3/4"-16 UNF)          | BI       |
| 0900233  | MGG20020 BB1A3 | 7.37       | 4 BOLT    | 9/16" KEYED | SAE -8 (3/4"-16 UNF)          | BI       |
| 0900234  | MGG20025 BB1A3 | 9.51       | 4 BOLT    | 9/16" KEYED | SAE -10 (7/8"-14 UNF)         | BI       |
| 0900235  | MGG20030 BB1A3 | 11.74      | 4 BOLT    | 9/16" KEYED | SAE -10 (7/8"-14 UNF)         | BI       |
| 0900371  | MGG20010 BC1A3 | 3.57       | SAE A 2B  | 9/16" KEYED | SAE -8 (3/4"-16 UNF)          | BI       |
| 0900384  | MGG20025 BB1D3 | 9.51       | 4 BOLT    | 9/16" KEYED | SIDE W/ SLOTTED BY-PASS VALVE | BI       |

| PART NO. | DESCRIPTION    | DISPL (CC) | FLANGE    | SHAFT       | SIDE PORTS           | ROTATION |
|----------|----------------|------------|-----------|-------------|----------------------|----------|
| 0900291  | MGG20010 BA1B3 | 3.57       | SAE AA 2B | 9/16" KEYED | SAE -8 (3/4"-16 UNF) | BI       |
| 0900293  | MGG20020 BA1B3 | 7.37       | SAE AA 2B | 9/16" KEYED | SAE -8 (3/4"-16 UNF) | BI       |

- 3.57cc – 11.74cc DISPLACEMENTS
- 2 BOLT SAE A MOUNT, 4 BOLT MOUNT
- 9/16" KEYED SHAFT
- SAE REAR PORTING STANDARD
- BI DIRECTIONAL



---

(Restricted for use by Parker Hannifin Personnel and Authorized Distributors) © 2015 Parker Hannifin Corporation



**Parker Canada Division**

Milton (905) 693-3000  
Montreal (514) 684-3000  
Calgary (403) 291-9284

[pcdmktg@parker.com](mailto:pcdmktg@parker.com)

**Parker Policy MI-WK092**

Confidential  
Effective Date: April 1<sup>st</sup> 2017  
Issue Date:  
Supersedes: N/A

[www.parker.com/hbuexpress](http://www.parker.com/hbuexpress)