

Tamper-proof relief valves

VA20, VA35 Relief Valves



Challenge:

Refuse front loaders and rear loaders use telescopic cylinders for the pack and eject functions. This component is typically the lowest pressure rated (2000 PSI) component on the truck and the most expensive.

In an attempt to increase the “work capacity” of these trucks, the end users would oftentimes increase the settings of the main and/or port relief valves. Often times, this results in premature component and structure damage to the trucks.

Solution:

Parker models L90 and K220 are pressure compensated, load-sense type valves that have the capability of selectively limiting the work port pressures via the feed reducers located in the work section. These feed reducers pass a minimal amount of flow to tank (0.25 GPM) when the target pressure is reached. Parker can add hardware to each section that will enable it to have flow-sharing capability. During flow sharing, in a pump over-demand condition, the speed of the selected functions will slow down but will maintain the speed relationship selected by the operator.



Reduced Lifetime
Ownership Costs



Increased
Safety

Success Factors:

- Allows for factory/dealer adjustments
- Unique adjusting screw, with added material to accommodate the locking wire
- Crimping tools that are readily available for MRO supply houses
- Custom crimping dies for additional deterrence and security
- Also available in V20 Series but accomplished with a crimped cap

Customer Values:

- Avoid premature failure of telescopic cylinder, saving ~\$4000
- Avoid premature pump failure, saving ~\$750-\$1000
- Avoid structure damage of cylinder mounts, saving ~\$2500
- Avoid downtime of at least 2-7 days
- Reduce warranty claims



ENGINEERING YOUR SUCCESS.

Schematic:

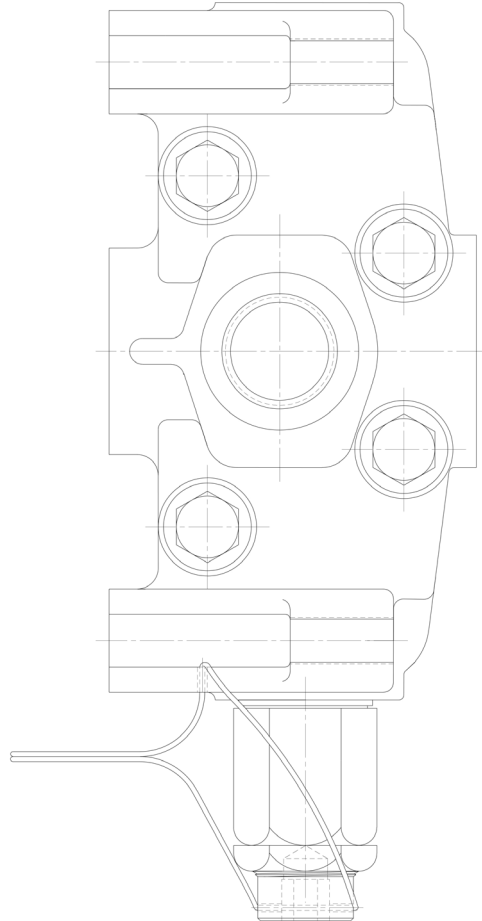

Contact Information:

Parker Hannifin Corporation
Hydraulic Valve Division

www.parker.com/hydraulicvalve